

Horizontal Self Cocking Jar

Technical Data Sheet
Assembly: 401-0250-002

The Omega Horizontal Self Cocking Jar is a long stroke hydraulic jar which has the unique capability of re-setting itself in a highly deviated or horizontal wellbore.

Whereas standard Hydraulic, spang or spring jars rely on gravity to re-set, the Omega Horizontal Jar incorporates a re-setting spring which provides sufficient re-setting force independent of deviation.

Originally designed to be run with the Omega Tractor, the Horizontal Jar provides greater flexibility to many non-tractor operations.

A unique feature of the Omega Horizontal Jar is the viscosity compensation metering system which maintains the metering time near constant regardless of the temperature.

The pressure balanced design offers a jar that will operate in nearly all environments without the need to change oil between runs or for differing well conditions.

When deployed with the Omega Hi-Deviation Tubular Jar & Roller Subs the Omega Horizontal Jar has operated in deviations of over 90 degrees.

Features

Re-setting spring.
Sealed hydraulic unit.
Compensating metering system.
Matched accelerators available.

Applications

Standard and Hi-Deviation wireline intervention.
Opening sliding side doors.
Utilised with Omega Roller Subs, Catapults & Tractors.
Wireline fishing operations.

Benefits

Self cocking mechanism reduces intervention time, risks, and costs.
Reliable firing mechanism over industry standard Hydraulic Jars.
Does not require to be 'pre-set' at surface. Activated via an overpull.
Hydraulic Cartridge design eliminates 'gassing up' issues commonly seen in hydro jars.

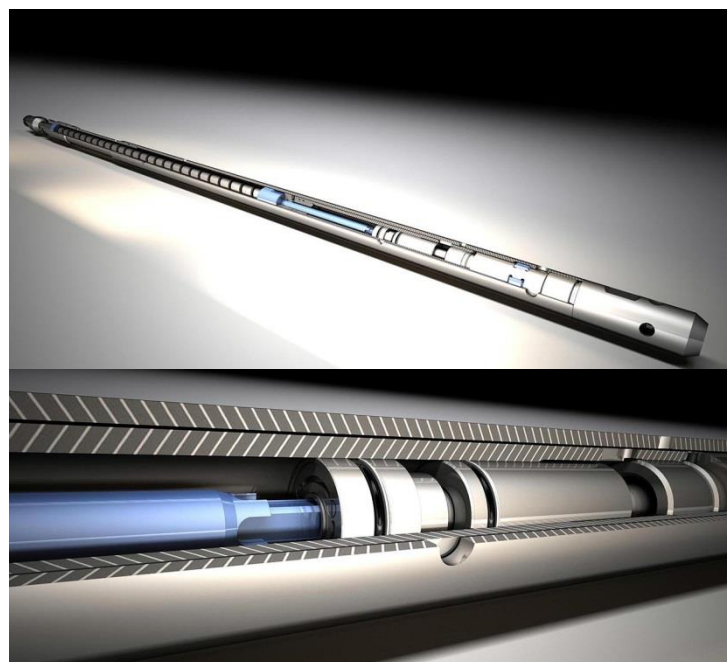

HI-DEVIATION



Omega

Omega Completion Technology Ltd.

Product Name

Technical Data Sheet

Assembly : 401-0250-002



Description	2.50" OD Horizontal Self Cocking Jar
Assembly Number	401-0250-002
Connections	1-7/8" HD QJR Male & Female
Tool Max. OD	2.50"
Fishing Neck	1.75" (Primary)
Fishing Neck	2.313" (Secondary)
Overall Length	96.7" Closed
Overall Length	118.0" Open
Stroke (Effective)	21.25"
Weight	93 lbs
Service	Standard
Max. Tensile Rating	78,650 lbs

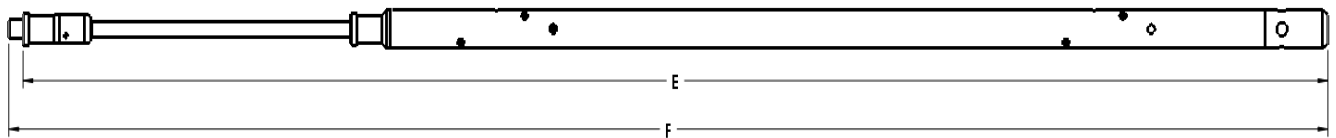
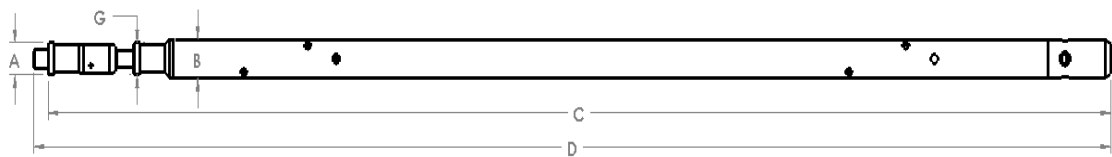

Dimensional Data	
A	1.75"
B	2.50"
C	95.75"
D	96.75"
E	117.0"
F	118.0"
G	2.31"

HI-DEVIATION

Omega Completion Technology Ltd
 Omega House
 Kirkhill Road
 Kirkhill Industrial Estate
 Dyce
 Aberdeen
 AB21 0GQ
 Tel: +44 (0)1224 772744
 Fax: +44 (0)1224 775667
 Email: info@omega-completion.com
<http://www.omega-completion.com>